



Brock's Performance • 4064 E. Patterson Road • Dayton, OH 45430 • Phone: 937-912-0054 • Fax: 937-912-0062

## KAWASAKI Z900RS (2018) WINDOW LINK™ KIT INSTALLATION INSTRUCTIONS

The fully adjustable Window Link™ Kit for the Kawasaki Z900RS (2018) allows for quick and easy seat-height adjustments from stock to lowered -3.00" without removing the links from the bike.

### Check Package Contents:

#### The Package Contents Include:

1. One (1) Upper Window Link™ Body
2. One (1) Lower Window Link™ Body
3. Two (2) Needle Bearings (Installed)
4. One (1) Adjustment Rod
5. One (1) Left-Hand Jam Nut
6. One (1) Right-Hand Jam Nut
7. Four (4) Bearing Dust Seals (Installed)

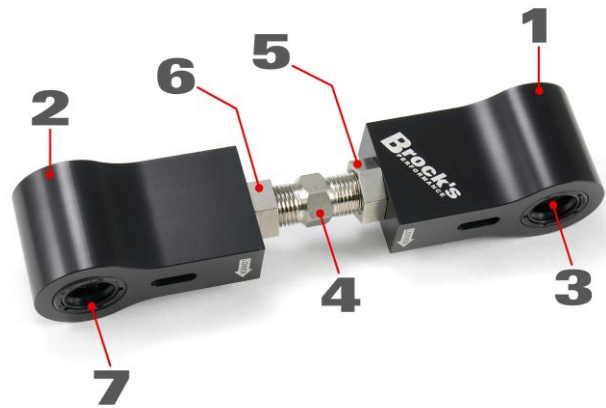

If your package contents differ, please contact Brock's Performance at 937-912-0054.

*For additional installation support please refer to your OEM service manual.*

### Removal Instructions:

**NOTE: Window Link™ installs using OEM nuts, bolts and bushings, do not discard.**

1. Properly support the bike and place a scissor jack (or similar type) beneath the engine. Insert a small piece of wood between the jack and engine to prevent metal-on-metal contact. Raise the bike so the rear wheel is just off the ground.
2. Remove two bolts/nuts securing the OEM tie rod (Fig 1 & 2).

**NOTE: Bolts should be easy to remove. If pressure is still on bolts, adjust the scissor jack up/down until the bolts slide free.**

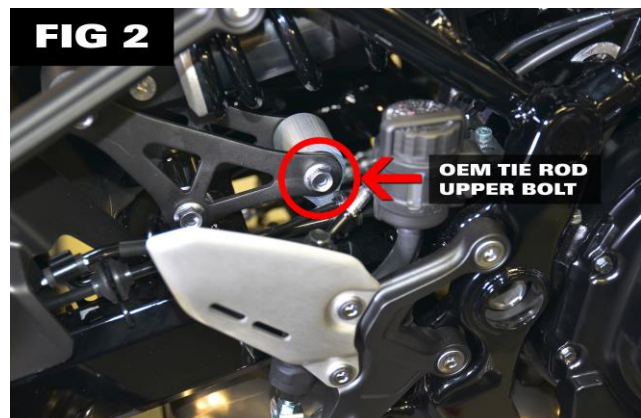
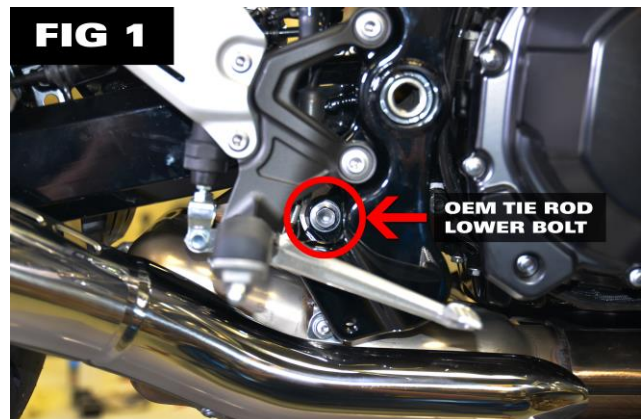

### Installation Instructions:

3. Apply waterproof grease to the needle bearings.
4. Remove two bushings from the OEM tie rod and transfer to the Upper and Lower Window Link Bodies (Fig 3).
5. Install Window Link assembly using the OEM nuts/bolts removed in step 2. For ease of adjustment, the 'Lower' arrows should point towards the rear of the bike (Fig 4).  
*Hand-tighten only.*
6. Lower the scissor jack to place the rear wheel back on the ground.
7. Torque the lower bolt first, then the upper. Torque to 33 lb-ft (45 N·m).
8. Turn the adjustment rod using a 5/8 wrench until the desired height is achieved (longer is lower). Tighten the jam nuts against the window link bodies to lock in the height adjustment.
9. After making any adjustment, check the window for visible threads. If no threads are visible **DO NOT** operate the bike (Fig 4).

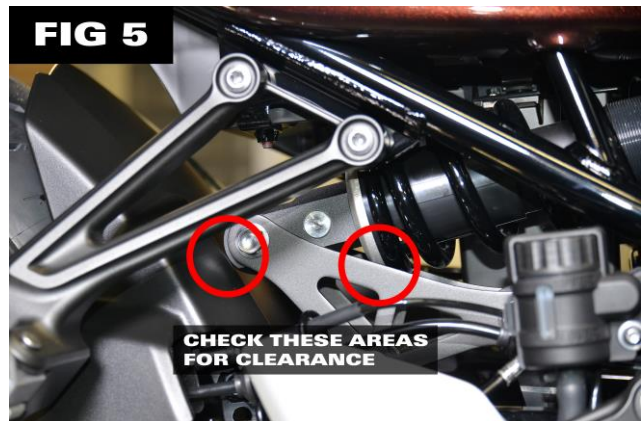
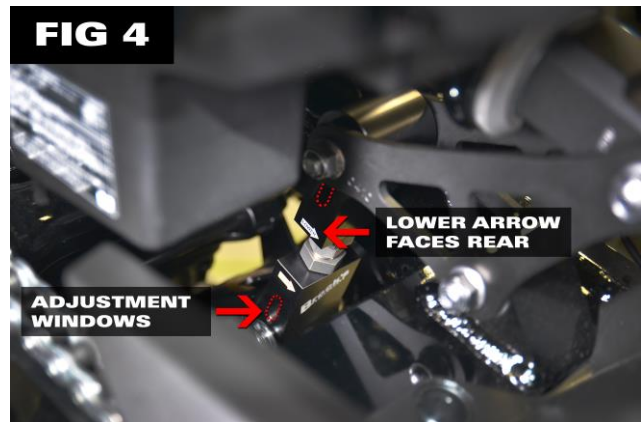

**NOTE:** Clearance between the OEM shock and rocker arms is required for proper suspension travel. Following any adjustment, check for appropriate clearance in these areas on the right-hand side of the bike (Fig 5).

**WARNING:** Chassis adjustments can alter the handling characteristics of any machine, and a lowered vehicle is more likely to experience obstacle and/or cornering clearance contact problems.

**ALL BROCK'S PERFORMANCE PRODUCTS ARE DESIGNED FOR CLOSED-COURSE RACETRACK USE ONLY!**

For more information on Brock's Performance Warranty and Terms and Conditions:

**BrocksPerformance.com > Brock's Support > Customer Service > Terms and Conditions**

For Questions and Comments:

**BrocksPerformance.com > Brock's Support > Customer Service > Contact Us or call 937-912-0054**