



*BST Carbon Fibre BMW K67
Swingarm*

Installation Guide

Congratulations on your purchase of your new BST Carbon Fibre BMW K67 Swingarm. Each swingarm is manufactured by hand with highly skilled technicians with up most attention to detail and passed through rigorous testing and development by world class engineers to ensure the highest level of quality is achieved on your unique swingarm.

Please carefully read this installation guide to ensure that all the necessary componentry and peripheral equipment is installed and transferred from your OEM swingarm.

From all of us at BST, we appreciate your support.

Contents

Parts to pre-purchase 3

 Critical..... 3

 Optional 3

OEM Swingarm Removal..... 3

Carbon Fibre Swingarm Preparation 5

Carbon Fibre Swingarm Installation 6

Disclaimer and important information 7

Parts to pre-purchase

Critical

- Chain master link part number: 27-72-7-720-938

Optional

- Sound Absorber part number: 27-00-8-529-962 (placed under chain slide)
- Chain slide guard part number: 33-35-8-361-542 (If you do not wish to alter the OEM component)

OEM Swingarm Removal

1. Remove the rear wheel from the OEM swingarm.



2. Unscrew the 4 plastic panel screws that secure the rear hugger/fender and chain guard to the swingarm (Star screwdriver).



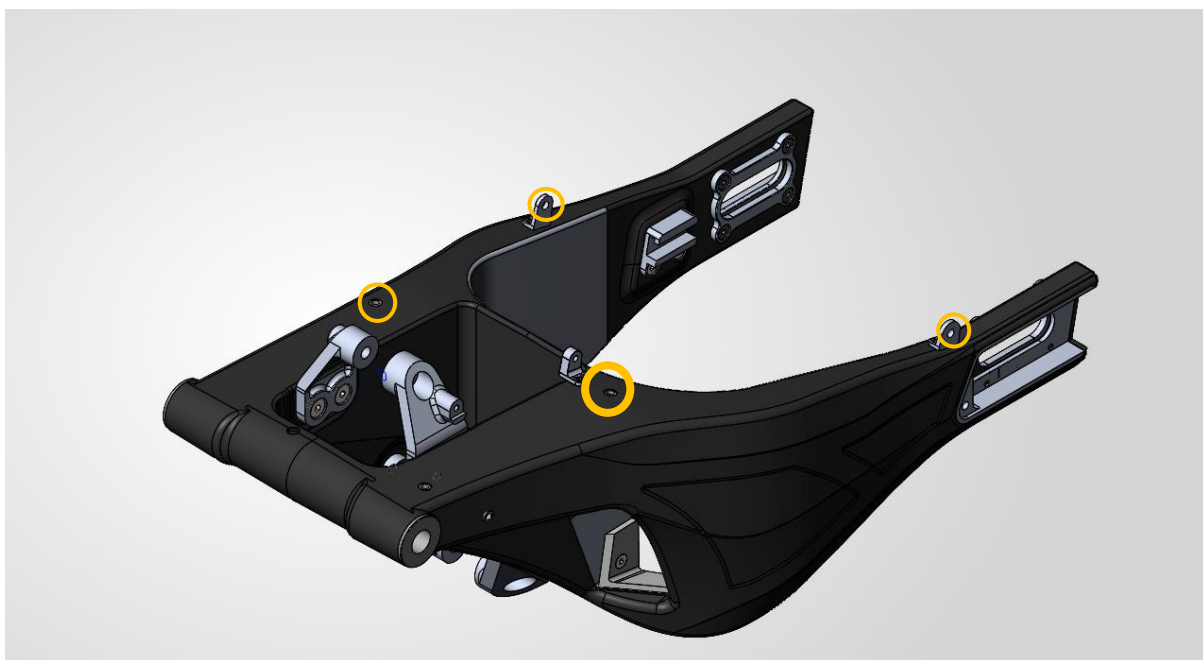

- The final screw holding the chain guard to the swingarm is an M5 Hex screw near the strut mount, remove and keep the M5 screw.

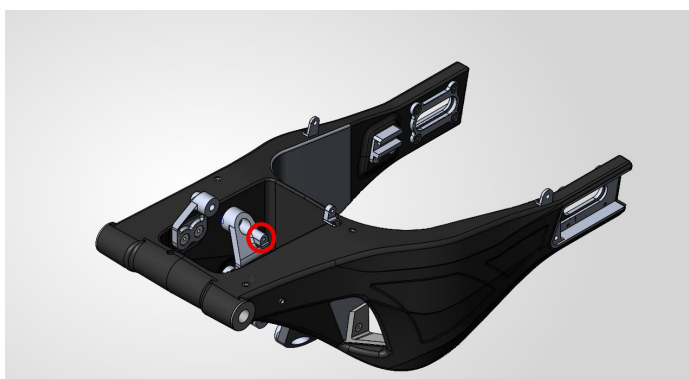

- Remove the hugger/fender and chain guard which will be put on your Carbon fibre swingarm later.
3. Remove the OEM brake calliper from its slide, all brake lines should be unclipped and can be hung over the rear set or pillion foot peg.
 4. Break the chain master link to allow for the chain to be removed.
 5. Unscrew the fastener that mounts the swingarm sensor strut, keep the screw as it will be used to mount the sensor on the Carbon Fibre swingarm

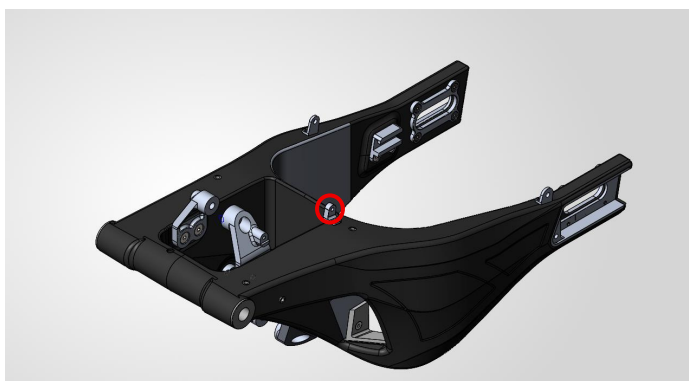

6. Remove the screw that secures the suspension strut (to be used on the Carbon Swingarm)
7. Remove the bolt that secures the shock at the lower shock mount (to be used on the Carbon Swingarm)
8. Remove the swingarm axle and set aside, the swingarm should be free to slide out of its position, with some manipulation of the dog bone assembly the swingarm should slide free from the suspension assembly.
 - If the suspension assembly does not clear enough for the swingarm to slide free of the assembly, remove the bolt securing the dog bone assembly which will free the entire shock assembly that can then be fastened to the Carbon swingarm upon installation.

Carbon Fibre Swingarm Preparation

1. Transfer the following components from the OEM Swingarm to the Carbon Fibre swingarm:
 - Hugger/fender (2x M6 Buttonheads and washers provided)
 - Chain Guards (side rail guard and swingarm chain guard. 3x M6 Buttonheads and washers provided)
 - Shock Assembly (if removed from main frame)
 - Swingarm sensor bolt
 - 2 plastic panel screws used on fender and chain guard standoff.
 - Wheel axle slides
 - Chain tension adjusting screws.
 - M5 Hex screw that fastens the chain rail guard to the shock adaptor
 - To ensure a perfect fit of the OEM swingarm chain guard, an edge needs to be ground away on the top left corner surface that wraps down into the swingarm wheel well.
2. Ensure the side spacers labelled 21017-10000-19-010-A are in place before fitting the carbon fibre swingarm. These spacers locate on the frame axle mount.

Carbon Fibre Swingarm Installation

1. Slide the prepared carbon fibre swingarm into place, feeding the shock assembly into position.
2. Line up the frame swingarm axle holes and feed the swingarm axle through, torque to OEM specifications.

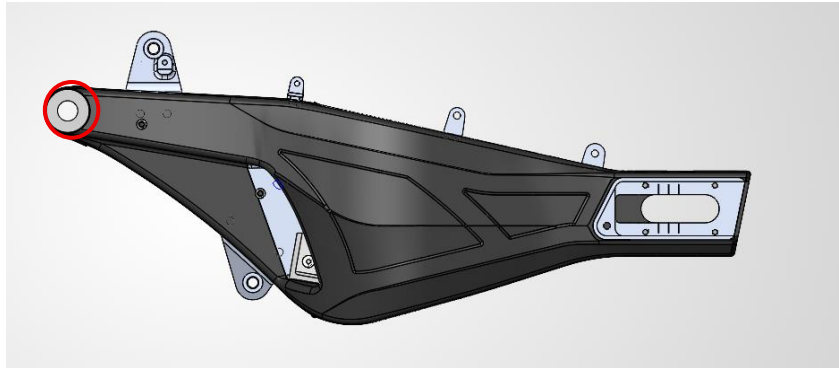

3. Align the shock assembly strut with the top mount of the swingarm and torque to OEM specifications.

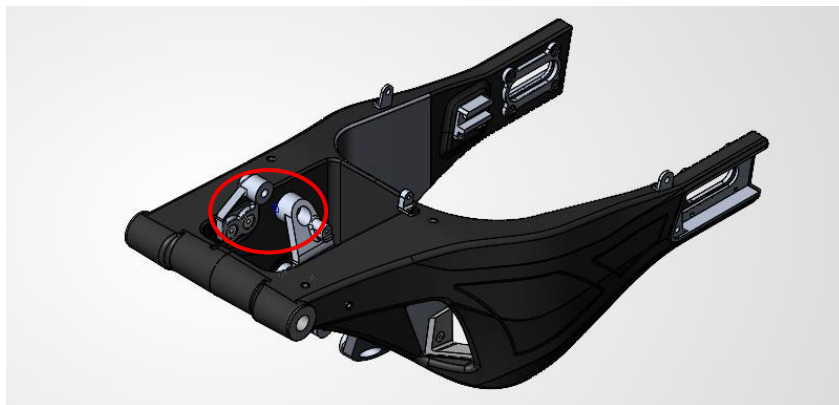

4. Align the shock assembly with the bottom shock mount and torque to OEM specifications.

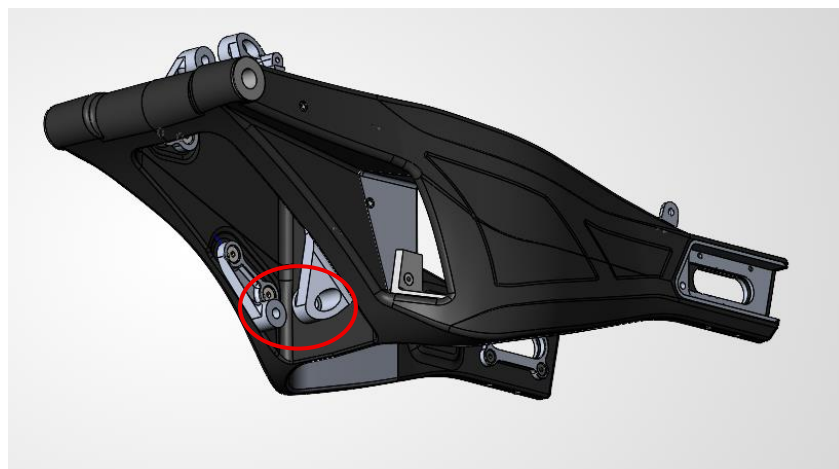

5. Reroute the brake line and slide the brake calliper into place
6. Reassemble the wheel to the swingarm
7. Attach the swingarm sensor to the pickup standoff



8. After your first ride, it is imperative that you check the torque on all critical points, namely: Shock mounts, swingarm axle mount and wheel axle.
9. **IMPORTANT NOTE:** This swingarm is designed to work with the OEM exhaust system and its clearance to the swingarm. If you are using an aftermarket exhaust system that is within 15mm (0.5905") of the swingarm, you need to heat wrap your exhaust system in the area that is within 15mm (0.5905") of the carbon fibre swingarm.

Disclaimer and important information

The BST Carbon Fibre BMW K67 Swingarm should only be installed by a professional, authorized workshop using the correct tools and assembly protocol to avoid potential safety risks due to improper installation.

This swingarm is designed to work with the OEM exhaust system and its clearance to the swingarm. If you are using an aftermarket exhaust system that is within 15mm (0.5905") of the swingarm, you need to heat wrap your exhaust system in the area that is within 15mm (0.5905") of the carbon fibre swingarm.