



Brock's Performance • 4064 E. Patterson Road • Dayton, OH 45430 • Phone: 937-912-0054 • Fax: 937-912-0062

SUZUKI KATANA (2020) FULL EXHAUST SYSTEM INSTALLATION INSTRUCTIONS

The Brock's Performance full exhaust system for the Suzuki Katana is a 4-2-1 high-performance full exhaust system that replaces the OEM muffler, catalytic converter, and head pipes.

Check Package Contents:

The Package Contents Include:

1. One (1) Penta-Carbon or AH2 Muffler
2. One (1) Left Head Pipe
3. One (1) Right Head Pipe
4. One (1) Collector
5. One (1) Midpipe
6. Four (4) Mounting Flanges
7. One (1) Permatex Ultra Copper
8. One (1) Package Containing Hardware
9. One (1) Package Containing Instructions



If your package contents differ, please contact Brock's Performance at 937-912-0054.

For additional installation support please refer to the OEM service manual.

Removal Instructions:

1. Support bike using a wheel stand or lift.
2. Remove seat.
3. Remove rear frame covers.
4. Remove side covers and front frame covers.
5. Remove fuel tank cover.
6. Remove rectifier cover and seat bracket.
7. Remove fuel tank.
8. Remove under cowl.
9. Remove muffler heat shield (Fig 1).
10. Loosen muffler clamp bolt (Fig 1).
11. Remove muffler mounting bolt and nut (Fig 1).
12. Remove the muffler.
13. Loosen jam nuts on exhaust servo (EXEV) cables and remove cables from exhaust servo valve (Fig 2).
14. Remove radiator bracket/coolant reservoir tank mounting bolts (Fig 3) and (Fig 4).
15. Pull rubber hose from slot and lay coolant reservoir unit down on workbench (Fig 5) and (Fig 6).
16. Disconnect oxygen sensor from harness (Fig 7).
17. Remove oxygen sensor from exhaust system (Fig 8).
18. Support underside of exhaust (catalytic converter) with a scissor jack (Fig 9).

Note: Place cardboard around the radiator to prevent damage to the aluminum fins during removal/installation.

19. Remove eight (8) head pipe mounting bolts (Fig 10).

Note: OEM head pipe mounting bolts will not be reused.

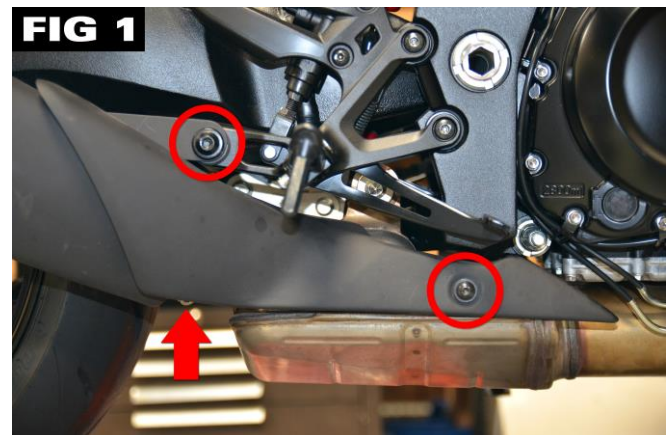

20. Remove two (2) bolts securing right side rider footpeg and let hang to allow clearance access to exhaust mounting bolt (Fig 11).
21. Remove nut and washer from exhaust mounting bolt (Fig 12).
22. Pull right side rider footpeg out of the way and remove exhaust mounting bolt from right side of bike (Fig 13).
23. Carefully lower scissor jack and remove OEM front section (one piece) from left hand side of bike.
24. Apply orange loctite to right side rider footpeg bolts, reinstall, and torque to 19.5 ft-lb (26.4 N·m).

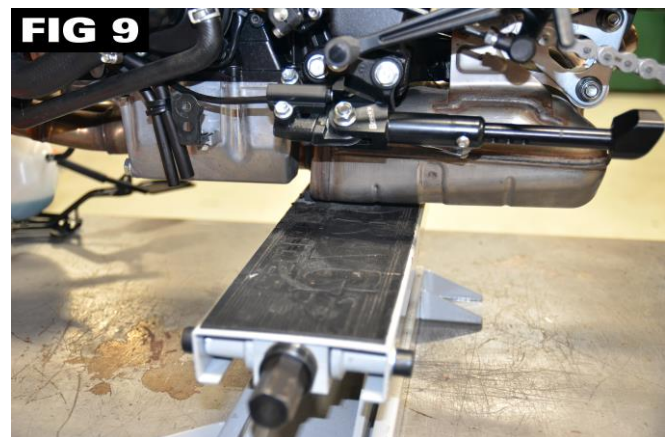
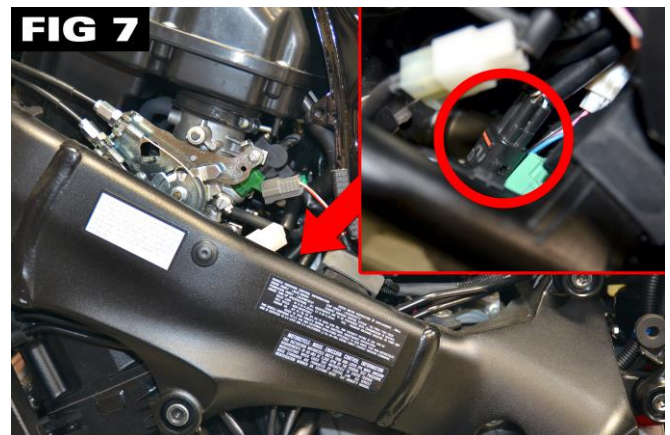
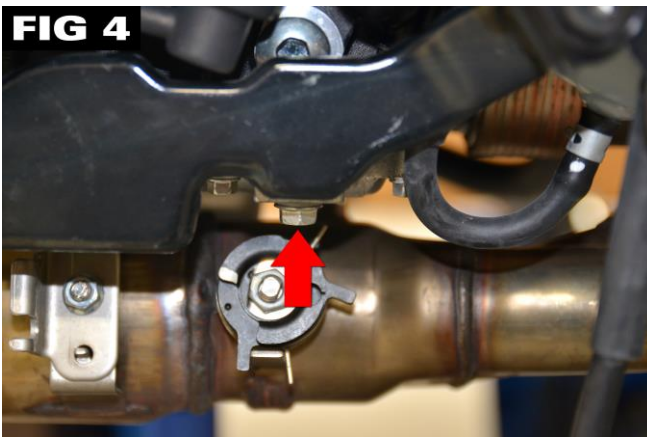
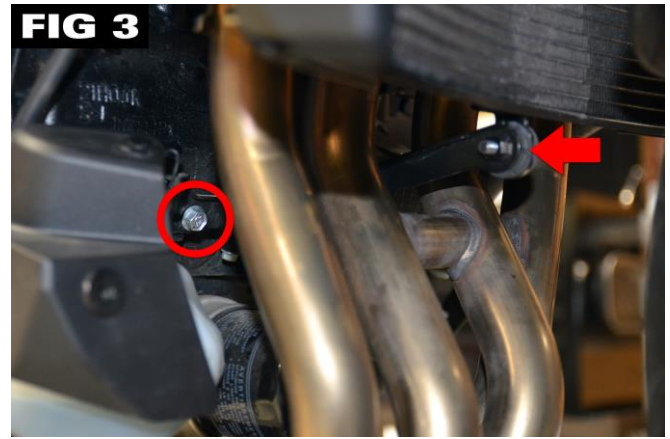

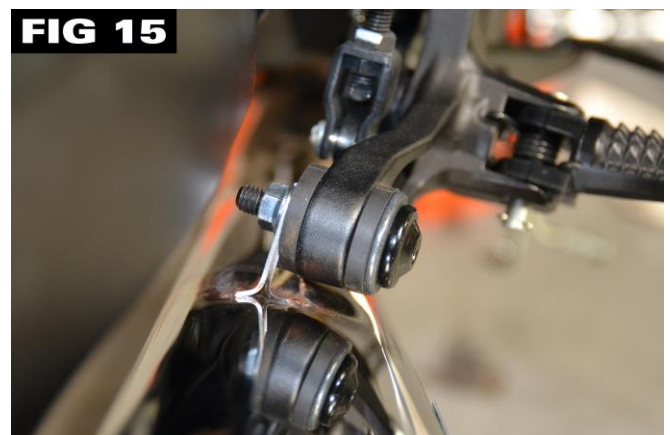
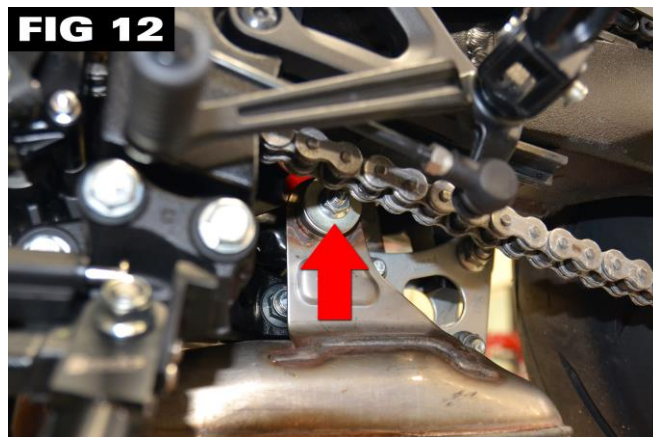
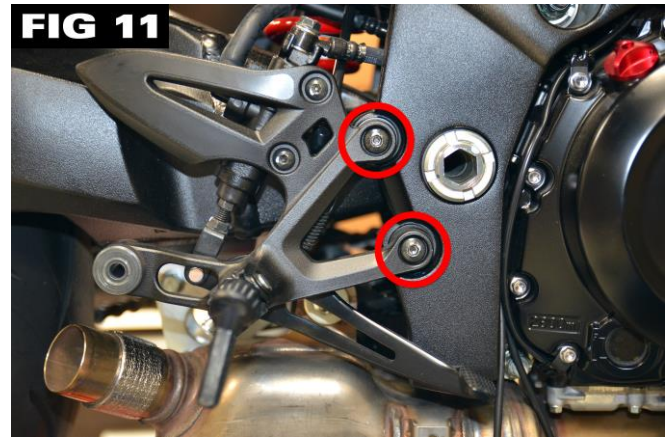

Installation Instructions:

Note: Before installing the performance exhaust system, preassemble all components to check fitment. A slight ovaling of the exhaust tubing can occur during production; this is normal. Apply WD-40® to the pipe joints to ease assembly, adjustment, and disassembly.

25. Inspect OEM exhaust gaskets for any damage and replace as needed.
26. Remove mounting flanges from head pipes. Install and secure hand tight with eight (8) supplied exhaust flange mounting bolts (Fig 14).
27. Apply a thin layer of Permatex Ultra Copper inside each head pipe up to ½" (12.5 mm) deep.
28. Install left and right side head pipes, collector, midpipe, and muffler.
29. Secure muffler to OEM muffler bracket using OEM muffler mounting bolt and nut hand tight (Fig 15).
30. Wiggle entire system to ensure pipes are fully seated.
31. Install one (1) spring to each head pipe (4 total) to secure to mounting flanges (Fig 16).
32. Install two (2) springs to secure the collector to the head pipes (Fig 16).
33. Install one (1) spring to secure the midpipe to the collector (Fig 16).

34. Install one (1) spring to secure the muffler to the midpipe (Fig 16).
35. Torque eight (8) exhaust flange mounting bolts to 17 ft-lb (23 N·m).
36. Torque muffler mounting bolt to 22.5 ft-lb (30 N·m).

Note: If the bike is equipped with a fuel tuned BrockFLASH ECU or Dynojet PCV, removal of the OEM oxygen sensor is required for optimum performance.

37. Using the supplied cap (or [Brock's PAIR Block Off Plates](#)) block off the PAIR system following the [supplemental instructions](#).
38. Reinstall radiator bracket/coolant reservoir tank and torque to 90 in-lb (10.2 N·m).
39. Remove EXCV cables per OEM Service Manual or follow alternate removal method below.
40. Using snips cut exhaust ends of EXCV cables (Fig 17).
41. Remove 2 screws from antilock brake (ABS) block to make room.
42. Use hemostats to remove clip and cables from EXCVA (Fig 18).
43. Reinstall ABS block screws.
44. Wipe down the entire exhaust system with rubbing alcohol.
45. Reinstall under cowling.
46. Reinstall fuel tank.
47. Reinstall seat bracket and rectifier cover.
48. Reinstall fuel tank cover.
49. Reinstall front frame covers and side covers.
50. Reinstall rear frame covers.
51. Reinstall seat.

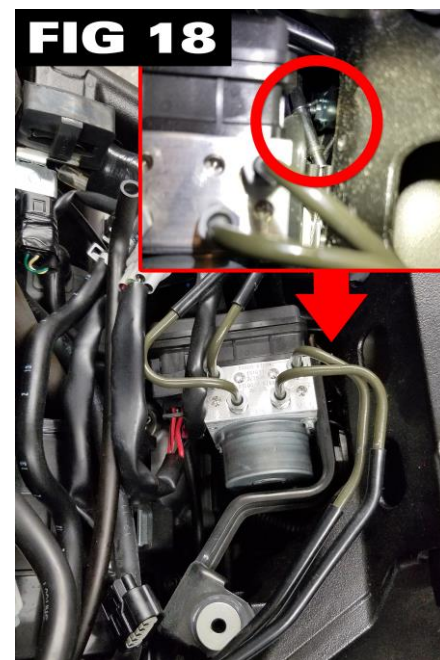
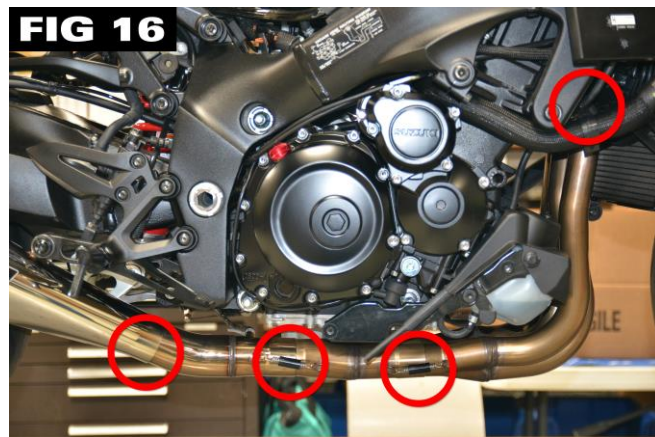

DO NOT START BIKE UNTIL A MINIMUM OF A 1/4-INCH (6 MM) CLEARANCE IS OBSERVED BETWEEN THE EXHAUST COMPONENTS AND ALL BODYWORK/PARTS.

- Failure to ensure proper clearance may result in burned plastic. Brock's Performance exhaust systems are designed to provide appropriate clearances. If minimum clearances are not obtained, remove the springs on the exhaust system and adjust until proper clearance is achieved.
- It is recommended that the entire exhaust system is wiped down with **rubbing alcohol** to remove oil and fingerprints before starting the bike. This will help prevent tarnishing of the finish after the exhaust has heated up.
- **Fender eliminator kits are recommended on some models; see [BrocksPerformance.com](#) for more details.**

Congratulations! Installation is complete.

ALL BROCK'S PERFORMANCE PRODUCTS ARE DESIGNED FOR CLOSED-COURSE RACETRACK USE ONLY!

For more information on Brock's Performance Warranty and Terms and Conditions:

BrocksPerformance.com > Brock's Support > Customer Service > Terms and Conditions

For Questions and Comments:

BrocksPerformance.com > Brock's Support > Customer Service > Contact us or call 937-912-0054