



[Brock's Performance](#) • 4064 E. Patterson Road • Dayton, OH 45430 • Phone: 937-912-0054 • Fax: 937-912-0062

KATANA (20-22), GSX-S1000 (17-20), and GSX-S750 (15-22) BrockSTAND™ PRODUCT INFORMATION

The Katana BrockSTAND™ is designed to easily provide users with a full range of adjustability from 'ultra-slammed' drag to street applications using only a 4mm hex key. Adjustment ranges: **Road Version 0.00" to 2.00"**

Package Contents:

Check Package Contents:

1. One (1) Black Anodized Body
2. One (1) Black Anodized Foot
3. One (1) Adjustment Bolt
4. One (1) Spring Mounting Stud
5. One (1) Safety Switch Plate
6. Two (2) Safety Switch Plate Mounting Bolts
7. One (1) Blue Threadlocker 0.5ml (not shown)

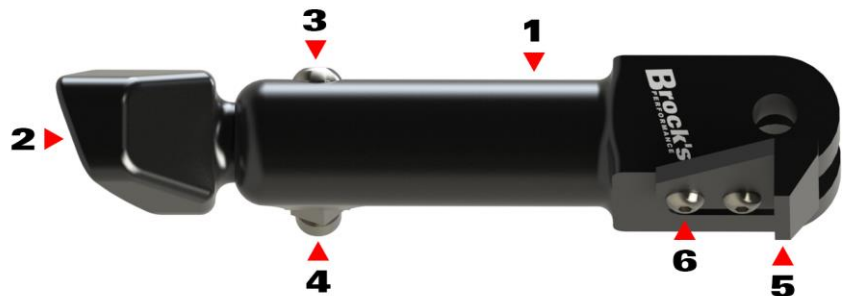

If your package contents differ, please contact Brock's Performance at 937-912-0054.

For additional installation support please refer to the OEM service manual.

Installation Notes:

- Install using the OEM kill switch, springs, and mounting hardware. See page 2 for side-stand installation and removal instructions from the OEM Katana service manual.
- When adjusting the foot length, it is recommended to apply blue threadlocker (supplied) to the threads of the Adjustment Bolt (3) before installation.
- Red threadlocker is applied to the Spring Mounting Stud (4) and Safety Switch Plate Mounting Bolts (6) during factory assembly. The Spring Mounting Stud (4) and Safety Switch Plate Mounting Bolts (6) should not be removed. In the event removal is required, apply red threadlocker to the threads before installation.
- **Installation Tip:** To ease spring removal/installation, fold the kickstand down to fully extend the spring. Place a penny between each of the open spring coils. When the kickstand is folded up, the spring will remain extended and be easier to remove/install.

Side-stand Construction

BENK07L29506003

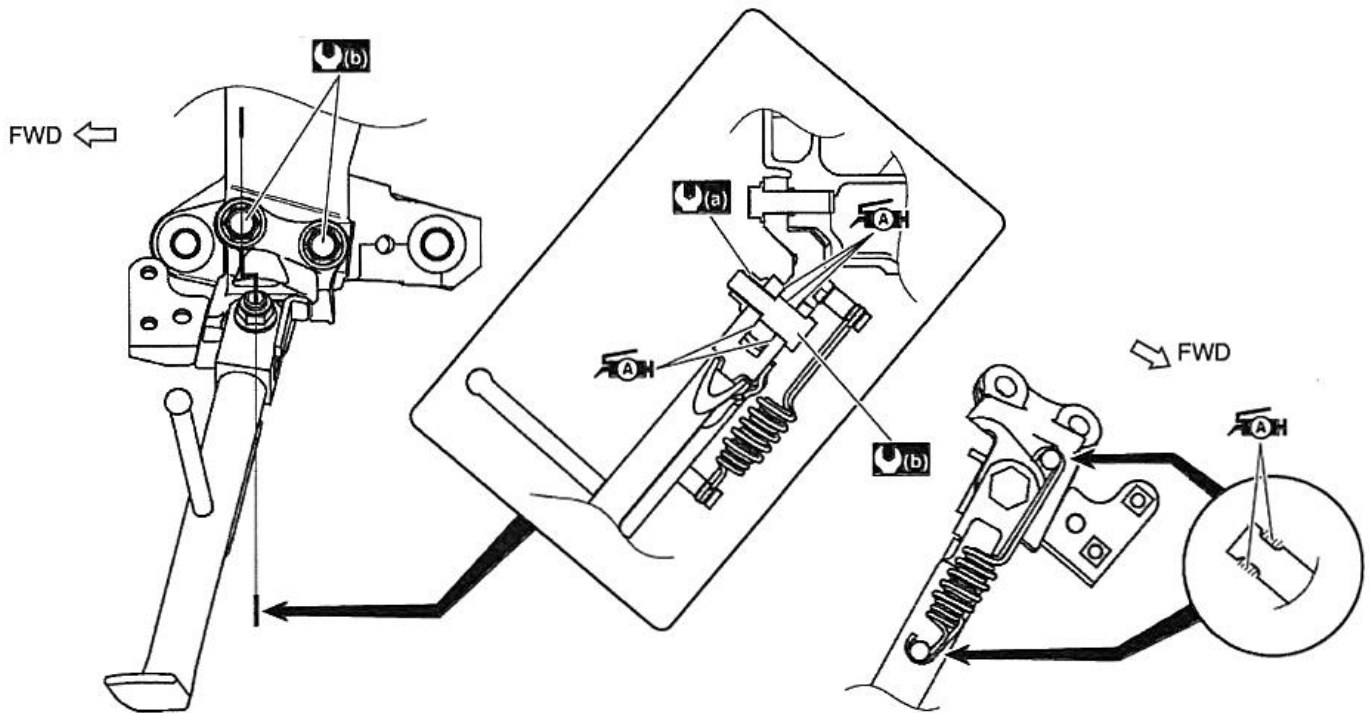

IK07L1950003-02

(a) : 40 N·m (4.1 kgf·m, 29.5 lbf·ft)	(AH) : Apply grease to the sliding surface.
(b) : 50 N·m (5.1 kgf·m, 37.0 lbf·ft)	

Side-stand Removal and Installation

BENK07L29506004

Refer to "Side-stand Construction" (Page 9E-3).

Removal

- 1) Support the motorcycle with a jack or wooden block.

▲ CAUTION

- Do not support the motorcycle with the exhaust pipes.
- Make sure that the motorcycle is supported securely.

- 2) Remove the side-stand.

Installation

Install the side-stand.

ALL BROCK'S PERFORMANCE PRODUCTS ARE DESIGNED FOR CLOSED-COURSE RACETRACK USE ONLY!

For more information on Brock's Performance Warranty and Terms and Conditions:

BrocksPerformance.com > Brock's Support > Customer Service > Terms and Conditions

For Questions and Comments:

BrocksPerformance.com > Brock's Support > Customer Service > Contact us or call 937-912-0054