



BPP-STRAP

Brock's
Performance
Products -
**Front End
Lowering Strap
Kit**



This Package contains:

- 1 Strap
- 1 Long Zip Tie
(to replace metal cable tie on Hayabusa only)
- 1 Shorter Reusable Zip Tie
(to secure strap handle)

Instructions for Standard Mount

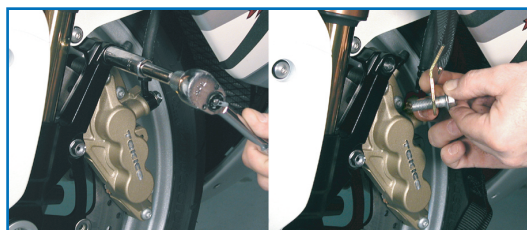

1. Remove TOP mounting bolt ONLY from both front brake calipers. Install release buckle end of strap on left side of bike (while seated) reusing the stock mounting bolt, as shown. Hand tighten.
2. Always route strap UNDER any cables and wires to prevent pinching or damage. Do not allow strap to twist. Route strap upward over steering neck and down the other side. Secure remaining end of strap as described in 1. Tighten strap slightly to remove slack. Torque stock mounting bolts on **both sides** to 39N·m (28 lb-ft).

Instructions for Radial Mount (BPP-RMSBK shown)

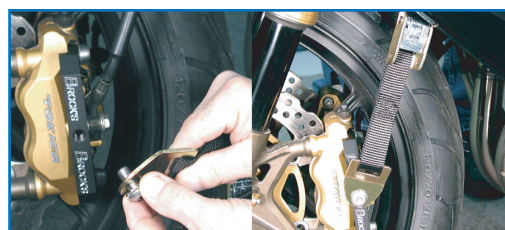

1. Install release buckle on left side of bike (while seated) using M10x20 bolt and serrated washer, as shown. Hand tighten.
2. Always route strap UNDER any cables and wires to prevent pinching or damage. Do not allow strap to twist. Route strap upward over steering neck and down the other side. Secure remaining end of strap as described in 1. Tighten strap slightly to remove slack. Torque M10x20 bolts on **both sides** to 39N·m (28 lb-ft).

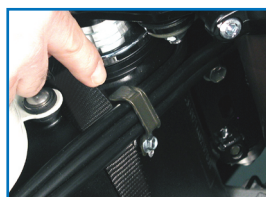

3. **Hayabusa only:** remove metal cable tie to prevent damage or binding to strap. Replace using permanent zip tie supplied with kit.



4. **To Lower Front End:**
Apply moderate pressure to front brake lever, lunge forward to compress front forks while simultaneously pulling upward on strap handle.
Attention: BIKE MAY FALL OVER!
Short kickstands are required on some models, contact Brock's Performance for details.



5. **DANGER: Strap handle MUST be securely fastened.** A loss of control can occur if the strap handle becomes tangled in the front wheel or brake assembly. Brock's Performance recommends a reusable Zip Tie to secure strap handle in a safe location.
To Raise Front End:
Press release buckle.

TEST FOR FULL STEERING TRAVEL BEFORE MOVING THE BIKE
The front end should travel stop to stop the same as it would without a strap.
Additional steering tension will be noticed while lowered.

Brock's Performance Products are designed for Closed-Course Racetrack use ONLY

For more information go to www.BrocksPerformance.com, click: **Installation Instructions**
email: advice@brockracing.com or call the **Tech Line 937-912-0061**

Brock's Performance Products policies and warranty information: www.BrocksPerformance.com, click: **Policies**