

Brock's Performance • 4064 E. Patterson Road • Dayton, OH 45430 • Phone: 937-912-0054 • Fax: 937-912-0062

## ABS DELETE V1.0 KAWASAKI ZX-14R (12-25) INSTALLATION INSTRUCTIONS

The Brock's Performance ABS Delete V1.0 for the ZX-14R allows for the full removal of factory ABS.

### Check Package Contents:

#### The Package Contents Include:

- One (1) ABS Delete V1.0

If your package contents differ, please contact Brock's Performance at 937-912-0054.

For additional installation support, please refer to the OEM service manual.



### Installation Instructions:

1. Remove seat.
2. Remove dashboards:
  - a. The dashboards are held in place by 3 fasteners (Fig 1).
  - b. Note that all dashboard and fairing fasteners have thin plastic washers between the fastener head and plastic bodywork. Save the plastic washers to be reused later.
  - c. With a two-handed grip on the inside of the dashboard, gently pull towards the forks to release the tabs holding the dashboard in place. Lift dashboard upwards to remove.
3. Remove left and right fairing grills:
  - a. Remove fasteners and washers at positions 1, 2, and 3 (Fig 2) for the right-side fairing grill.
  - b. Note the bolt tab positioned under the tank cover at fastener #1, pull tank cover away slightly to release tab. The dotted line shows location of the hidden tab (Fig 2).
  - c. The fairing grill is now held in place by two rubber snap grommets inserted into the mid-fairing. Pull the fairing grill away from the mid-fairing slightly and slide fairing to the rear to remove. Red circles show locations of hidden snap grommets (Fig 2).
  - d. Repeat for left-side fairing grill.

**Caution:** When performing the steps below use extreme care when releasing tank cover from side fairing grommets. The mounting tab has been known to break easily.

4. Remove tank cover:
  - a. The tank cover is held in place by 3 fasteners (Fig 3). Fastener #1 is located on the right side, fastener #2 on the left side, and fastener #3 at the front of the tank cover.
  - b. The tank cover is now held in place by pins.
  - c. Pull the tank cover in an outward direction on both sides to clear the grommets and hooks. Then lift the tank cover to remove it from the bike frame.

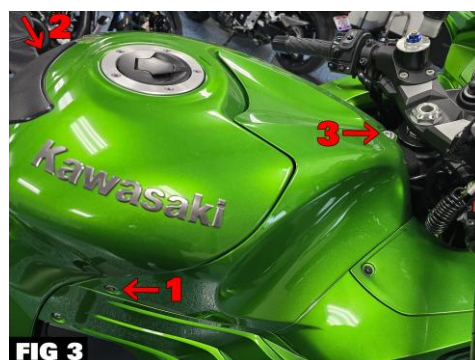



5. Remove the fuel tank:
  - a. The fuel tank is held in place by four fasteners (Fig 4).
  - b. Disconnect the fuel pump connector and fuel level sensor connector (Fig 5).
  - c. With a paper towel or shop rag placed below to catch any spillage, disconnect the fuel line from the tank (Fig 6).
6. Disconnect the rear ABS sensor connector (Fig 7).
7. Remove the ABS cover. The ABS cover is held in place by four fasteners (Fig 8).
8. Disconnect the ABS connector from the ABS unit (Fig 9).
9. Pull the orange tab upwards to release the connector.
10. Install the Brock's Performance ABS Delete V1.0 (Fig 10).
11. If retaining ABS pump, secure ABS Delete as shown (Fig 11).
12. Reinstall ABS cover, fuel tank, and bodywork in the reverse order of removal.

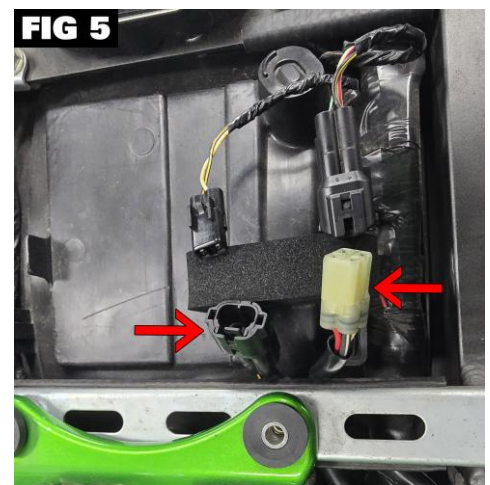
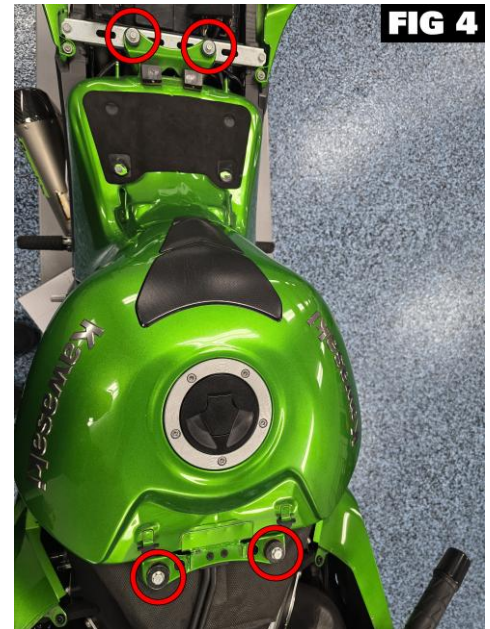

## Congratulations! Installation is complete.

**ALL BROCK'S PERFORMANCE PRODUCTS ARE DESIGNED FOR  
CLOSED-COURSE RACETRACK USE ONLY!**

For more information on Brock's Performance Warranty and Terms and Conditions:  
**BrocksPerformance.com > Brock's Support > Customer Service > Terms and Conditions**

For Questions and Comments:  
**BrocksPerformance.com > Brock's Support > Customer Service > Contact us or call 937-912-0054**

